

# The Most Advanced and Robust High Pressure System Available

CUT FASTER | INCREASE PRODUCTION | LOWER COSTS

## BENEFITS OF HYPERPRESSURE 87,000 psi vs. 60,000 psi

- Cuts 20-30% faster
- Uses 30-50% less abrasive
- Delivers 20-30% lower part cost
- Reduces taper by up to 0.001"

## STANDARD FEATURES

- Dual 87,000 psi Intensifiers with ECL — Extended Component Life parts
- Durable pump design with full intelligent controls, monitoring and communication ability
- High efficiency hydraulic system with redundancy
- Fully integrated with diagnostics and remote monitoring at computer console
- Additional control panel at pump for easy operation and maintenance

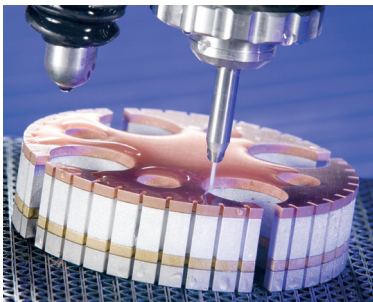

## Cut Faster

HyperPressure — 87,000 psi — is a substantial 45% increase in pressure from traditional 60,000 psi ultrahigh-pressure systems. At 87,000 psi the waterjet velocity increases beyond Mach 3 — creating a faster, more powerful cutting tool for any material.

From stone to aluminum, steel and exotic composites, increases of 20-30% in cutting speeds are a result of accelerating the abrasive waterjet stream to the fastest, most powerful pressure available. Regardless of material or thickness, cutting speeds increase with higher pressure.

## Increase Production

Faster cutting speeds mean more parts can be cut; throughput for any shop will increase. From in-house production to custom fabrication and contract manufacturing shops, more jobs can be completed in less time with an 87,000 psi HyperPressure waterjet.

As business grows and floor space becomes scarce, additional machinery is often the only answer. Increased production capability with Flow's exclusive 87,000 psi HyperPressure waterjet systems will accommodate growth in every business without increasing floor space, utility requirements or employees.

## Lower Costs

Higher speeds and increased production doesn't come at a higher cost — 87,000 psi HyperPressure pumps cost less to operate. HyperPressure pumps operate at 45% higher pressure, moving abrasive particles faster. As a result, each abrasive particle carries more momentum and cutting power. Therefore, fewer abrasive particles are required as compared to lower pressure pumps. With abrasive costs representing a majority of the operating cost of any waterjet pump, using 30-50% less abrasive with an 87,000 psi HyperPressure pump will save money. This results in a lower operating cost than traditional pumps at lower pressure.

Lower operating costs combined with increased speeds mean the cost per part or contract job will be greatly reduced. The option of running a more efficient shop, producing more parts in less time at a lower cost makes the exclusive Flow HyperPressure pump a clear choice.

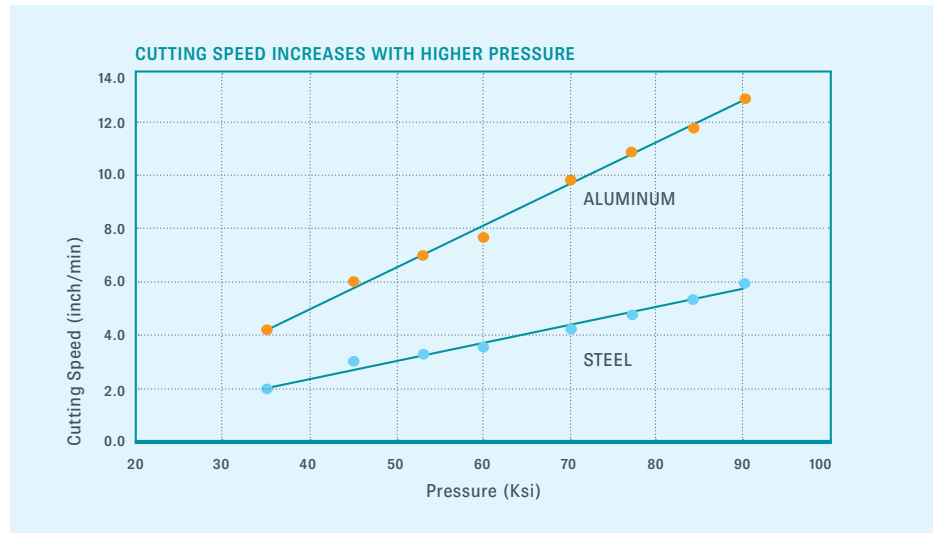

## HISTORY OF INNOVATION

Every high pressure waterjet advancement has been first introduced by Flow — higher pressure creates more powerful and efficient cutting.

1970's	1980's	1990's	2006
Flow introduces the 30,000 psi waterjet cutting system	Flow invents and introduces the abrasive waterjet Flow pioneers the long-life 40,000 psi systems Flow creates the 55,000 psi standard	Flow introduces the 60,000 psi systems Flow introduces the first HyperPressure 100,000 psi pumps for special applications	The latest innovation -- Flow releases the first 87,000 psi HyperPressure pump for commercial applications

## INTEGRATED HYPERPRESSURE SYSTEM DESIGN

- Flow's 87,000 psi HyperPressure technology system isn't only a pump — it is a complete system designed to increase cutting power and speed while reducing operating cost. Every component that delivers the most powerful waterjet performance is part of the integrated HyperPressure system.
- Advanced PASER® Mach4™ cutting head system with higher cutting vacuum designed specifically for 87,000 psi performance
- Quick acting on/off valve for faster cycle times and rugged construction
- Proprietary high pressure plumbing materials and design from the pump to the cutting head to maximize cutting performance
- Enhanced computer cutting models created exclusively for HyperPressure cutting efficiencies
- Reduced noise from pump to cutting jet
- Exclusive tools developed by Flow to ensure easy, consistent and reliable maintenance at higher pressures

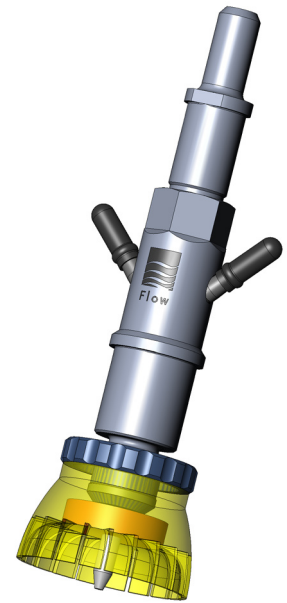

## SPECIFICATIONS

Pump Power Flow Rate	Continuous Operating Pressure	Voltage
HyperJet 50 is	50 HP 0.8 gpm Adjustable up to 87,000 psi	400/480 VAC, 150 KVA
HyperJet 100 id	100 HP 1.4 gpm Adjustable up to 87,000 psi	400/480 VAC, 225 KVA

## INNOVATION | EXPERTISE | COMMITMENT

### Get It All with Flow

For over three decades, Flow has set the standard for excellence in waterjet technology. We are the only waterjet company in the world that offers total solutions and support from a single source, both before and after your waterjet system is installed. We learn your business requirements. We help you select and implement the right solution. We train your staff and we are there for you for the entire lifecycle of our products.

### When you partner with Flow, you get more than a product:

Our **INNOVATION** ensures that you will always have the latest and highest quality technology.

Our **EXPERTISE** ensures that you will always have the right technology for your individual business needs.

Our **COMMITMENT** to customer service ensures that you will always receive the support you need to stay productive.

For your complimentary needs analysis or a product demonstration, please call one of our waterjet experts at **1-800-446-3569**.

We look forward to partnering with you in your success.

UNITED STATES, CANADA, MEXICO, CARIBBEAN,  
AUSTRALIA, & NEW ZEALAND  
Flow Waterjet Americas  
23500 64th Avenue South, Kent, Washington 98032 USA  
Tel: 253-850-3500 • Fax: 253-813-3285  
TOLL-FREE: 800-446-3569 • info@flowcorp.com  
www.flowcorp.com

CENTRAL AMERICA & SOUTH AMERICA  
Flow Waterjet Americas • Tel: +55-11-3616-2822  
flowlatino@flowlatino.com • www.flowlatino.com

EUROPE, MIDDLE EAST, & AFRICA  
Flow Waterjet Europe • Tel: +49-7252-538-0  
info@floweurope.com • www.floweurope.com

SOUTHEAST ASIA, KOREA, & CHINA  
Flow Waterjet Asia • Tel: +886-3-577-2102  
inquiry@flowasia.com.tw • www.flowasia.com

JAPAN  
Flow Waterjet Asia • Tel: +81-52-701-7021  
fjc@flowjapan.co.jp • www.flowjapan.co.jp

